

REV	ECN	DESCRIPTION	BY/DATE	CHK	APPR
A	8231	ADDED MARKING VIEW A-A ROTATED 180° CW	RLA 01/12/12	LN	<i>[Signature]</i>

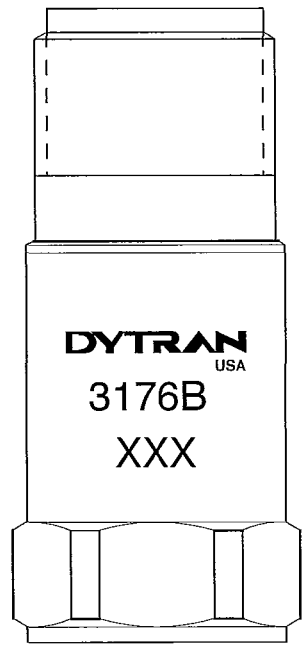

VIEW A-A
ROTATED
180° CW

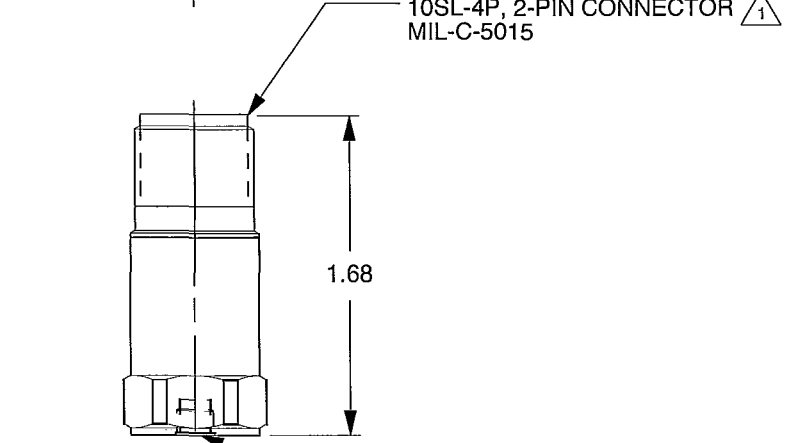
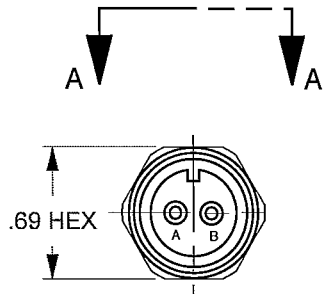
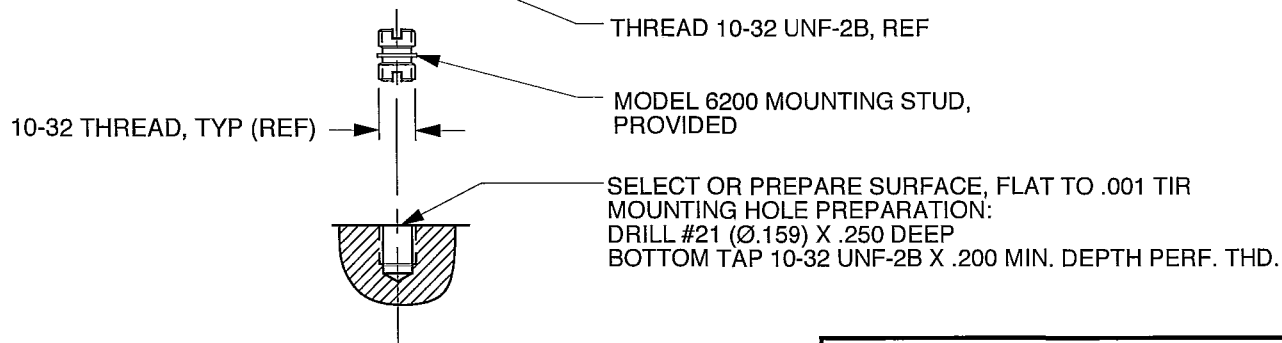

△ PINOUT: A- SIGNAL
B- GROUND RETURN

EXCEPT AS OTHERWISE NOTED

ALL DIMENSIONS IN INCHES
TOLERANCE: .XXX ± .XX ±

SURFACE FINISH ✓
EXCEPT AS NOTED

BREAK EDGES TO DEBURR
RADIUS OR CHAMFER

△ THESE DIAS **⊙** TO T.I.R.

FILLETS - MAX RAD.

DYTRAN INSTRUMENTS, INC.		MASTER ONLY IF IN RED		CHATSWORTH, CA.	
SCALE	1X	REV	DATE	SEE REV BLK	ECN
DATE	5/2/02	PART NO.	MODEL 3176B		
DRAWN	N.C.	CHECKED	R.A.		
APPROVED	PML	09/23/05	NEXT ASSEMBLY	USED ON	
TITLE			DWG NO.		
OUTLINE/INSTALLATION DRAWING, MODEL 3176B			127-3176B		
			SHEET 1 OF 1		

Model Number 3176B	PERFORMANCE SPECIFICATION	DOC NO PS3176B
	IEPE ACCELEROMETER	REV A, ECN 12601, 04/04/16



- HIGH SENSITIVITY
- ELECTRICALLY ISOLATED
- HERMETICALLY SEALED

PHYSICAL

Weight, Max.
Connector
Type Pins
Mounting Provision
Material (Case/Connector)
Element Type

ENGLISH		SI	
	1.6	oz	44
	MIL-C-5015		MIL-C-5015
	2-PIN		2-PIN
	Tapped 10-32 Hole		Tapped 10-32 Hole
	300 Series S.S.		300 Series S.S.
	Piezoceramic, Planar Shear		Piezoceramic, Planar Shear

PERFORMANCE

Sensitivity, ±5% [1]
Range F.S for ± 5 Volts Output
Frequency Response, ±10%
Mounted Resonant Frequency
Equivalent Electrical Noise Floor
Amplitude Non-Linearity, Max. [2]
Maximum Transverse Sensitivity
Strain Sensitivity @ 250/μ ϵ

	100	mV/g	10.2	mV/m/s ²
	±50	g	±490.5	m/s ²
	0.3 to 10,000	Hz	0.3 to 10,000	Hz
	> 27	kHz	> 27	kHz
	0.00002	Grms	0.0002	m/s ² rms
	±2	% F.S.	±2	% F.S.
	5	%	5	%
	0.0001	g/μ ϵ	0.001	m/s ² /μ ϵ

ENVIRONMENTAL

Maximum Vibration
Maximum Shock
Temperature Range
Seal

	500	G's, peak	4905	m/s ² peak
	5000	G's, peak	49050	m/s ² peak
	-60 to +250	°F	-51 to +121	°C
	Hermetic		Hermetic	

ELECTRICAL

Supply Current Range [3]
Compliance Voltage Range
Output Impedance, Typ.
Output Bias Voltage
Discharge Time Constant
Output Signal Polarity
Electrical Isolation, Ground Pin to Case

	2 to 20	mA	2 to 20	mA
	+20 to +30	Volts	+20 to +30	Volts
	200	Ω	200	Ω
	+11 to +13	VDC	+11 to +13	VDC
	0.9 to 2.0	Sec	0.9 to 2.0	Sec
	Positive for Acceleration Toward Top		Positive for Acceleration Toward Top	
	10	GΩ, min	10	GΩ, min

This family also includes:

Model	Sensitivity	Range F.S ± 5 Volts	Max Vibration/Shock	Resonant Frequency

Refer to the performance specifications of the products in this family for detailed description

Supplied Accessories:

- 1) Accredited calibration certificate (ISO 17025)
- 2) Mounting Stud Model 6200S, 10-32 to 10-32

Notes:

- [1] Measured at 100Hz, 1 Grms per ISA RP 37.2
- [2] Measure using zero-based straight line method, % of F.S. or any lesser range.
- [3] Do not apply power to this system without current limiting, 20 mA MAX. To do so will destroy the IC charge amplifier.

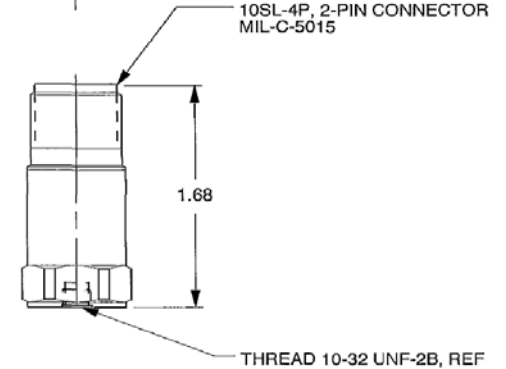
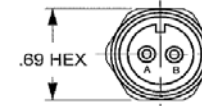
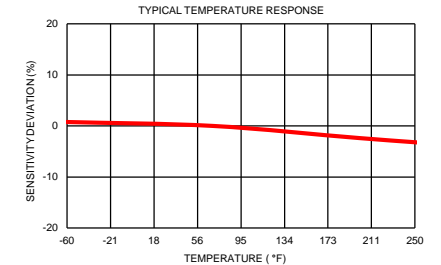
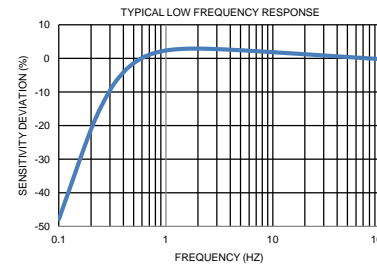

Units on the line drawing are in inches, units in brackets are in millimeters. Refer to 127-3176B for more information.



21592 Marilla Street, Chatsworth, California 91311 Phone: 818.700.7818 Fax: 818.700.7880 www.dytran.com
For permission to reprint this content, please contact info@dytran.com