

PROPRIETARY AND CONFIDENTIAL

THE INFORMATION CONTAINED IN THIS DRAWING IS THE SOLE PROPERTY OF DYTRAN INSTRUMENTS INC. ANY REPRODUCTION IN PART OR AS A WHOLE WITHOUT THE WRITTEN PERMISSION OF DYTRAN INSTRUMENTS INC. IS PROHIBITED

REVISIONS

| REV. | ECN | DESCRIPTION | BY/DATE | CHK | APPR |
|------|-------|--|-------------|-----|------|
| A | 14328 | INITIAL RELEASE | DP 08/03/18 | RA | LN |
| B | 14353 | ADDED MARKING: "S/N XXX" REMOVED REFERENCE DIMENSIONS | KG 08/10/18 | KG | LN |

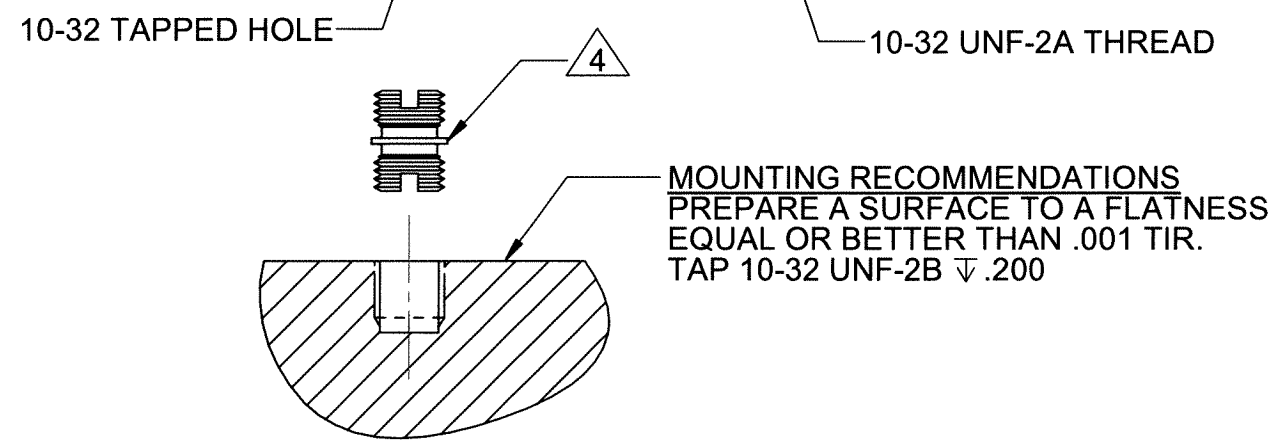
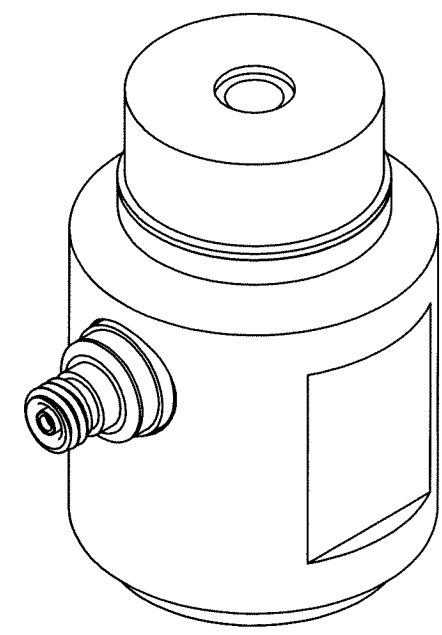
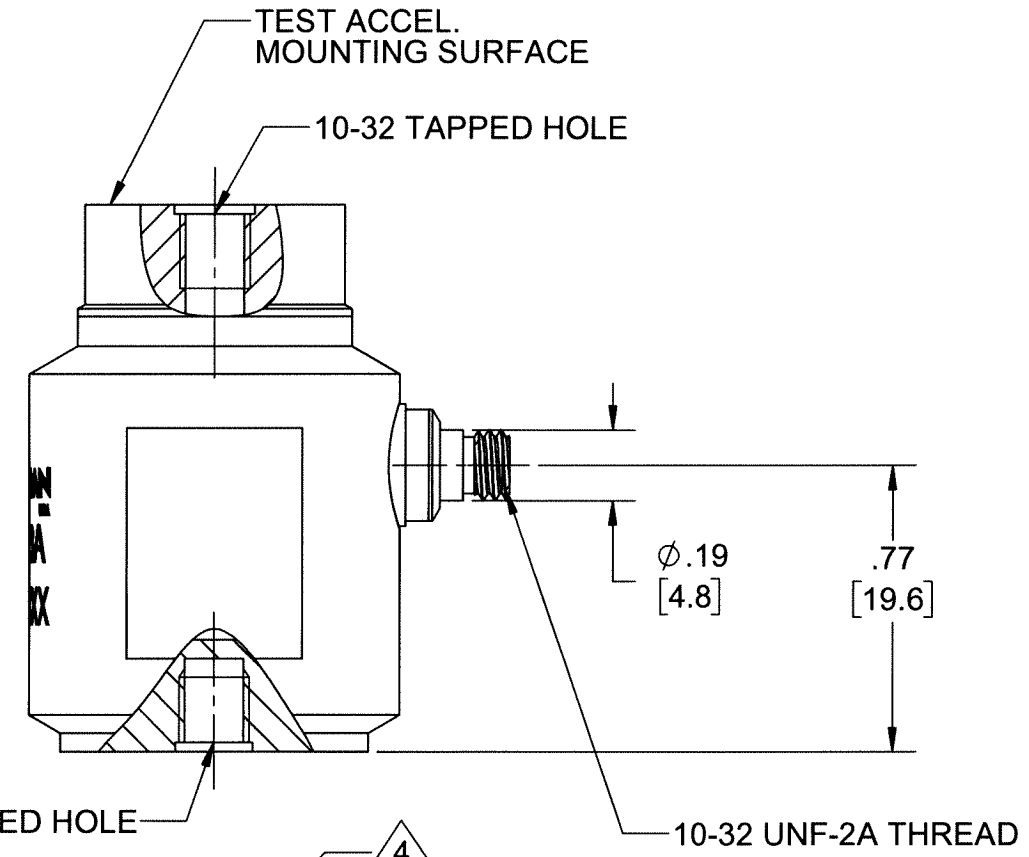
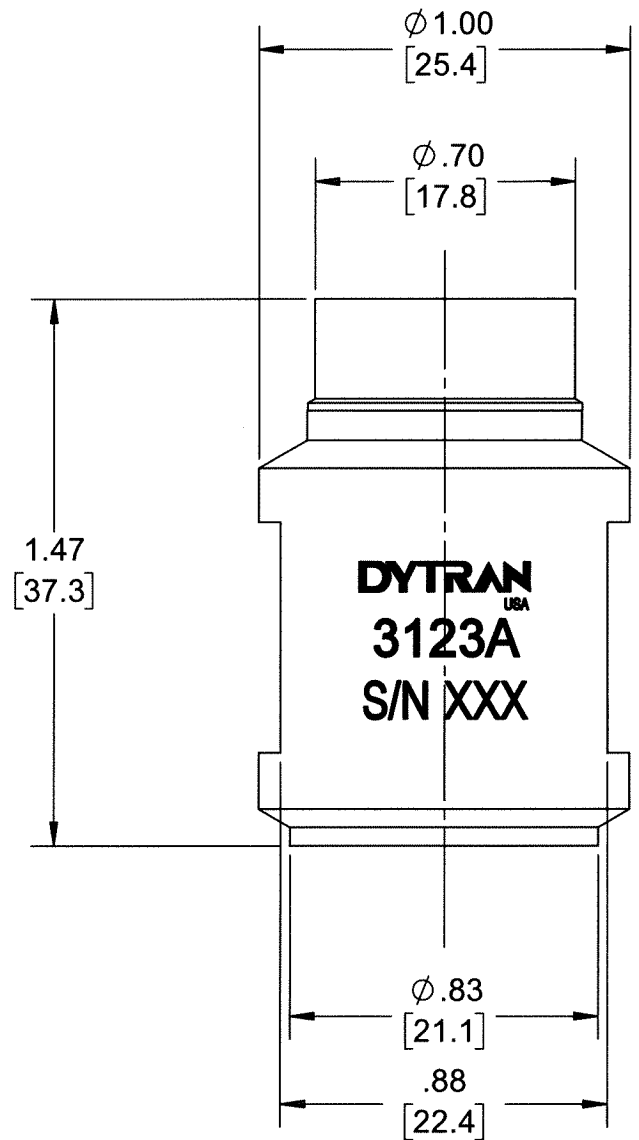

- 4 MOUNTING STUD MODEL 6200 SUPPLIED.
- 3. WEIGHT: 45 GRAMS, MAX
- 2. INSTALLATION TORQUE: 15 LB-IN ON TWO FLATS.
- 1. MATES WITH 6011AXX CABLE.

NOTES: UNLESS OTHERWISE SPECIFIED

| | | | | | | |
|--|--|---|---------------------------|------------------------------|--|--------------------------------|
| <small>UNLESS OTHERWISE SPECIFIED: INTERPRET DIM & TOL PER ASME Y14.5M - 1994. REMOVE BURRS. COUNTERSINK INTERNAL THDS 90° TO MAJOR DIA. CHAM EXT THDS 45° TO MINOR DIA. THD LENGTHS AND DEPTHS ARE FOR MIN FULL THDS. DIMENSIONS APPLY AFTER FINISHING.</small> | <small>UNLESS OTHERWISE SPECIFIED: DIMENSIONS ARE IN INCHES. DIMENSIONS IN BRACKETS [] ARE IN MILLIMETERS TOLERANCES ARE:</small> | | | MASTER ONLY IF IN RED | | |
| | <small>DECIMALS .XX ±.03 .XXX ±.010</small> | <small>METRIC .X ± 0.8 .XX ± 0.25</small> | | | | <small>ANGLES ±1°</small> |
| | APPROVALS | | | DATE | TITLE: OUTLINE/INSTALLATION DWG, MODEL 3123A | |
| | <small>ORIG</small> NC | <small>CHK</small> RA | | <small>DATE</small> 07/10/96 | <small>SIZE</small> B | <small>CAGE CODE</small> 2W033 |
| <small>APP</small> LN | | <small>DATE</small> 08/06/18 | <small>SCALE:</small> 2:1 | | <small>SHEET</small> 1 OF 1 | |

| | | |
|---------------------------|----------------------------------|----------------------------|
| Model Number 3123A | PERFORMANCE SPECIFICATION | DOC NO PS3123A |
| IEPE ACCELEROMETER | | REV D, EGN 16087, 02/17/21 |



• **ACCELEROMETER FOR BACK-TO-BACK CALIBRATION**

PHYSICAL

Weight, Max Connector
 Mounting Provision Top and Bottom Tapped Holes
 Material Housing and Connector
 Element Style Type

| ENGLISH | | SI | |
|----------------------------|----|----------------------------|-------|
| 3.0 | oz | 85 | grams |
| 10-32 Coaxial | | 10-32 Coaxial | |
| 10-32 | | 10-32 | |
| 300 Series Stainless Steel | | 300 Series Stainless Steel | |
| Planar Shear | | Planar Shear | |

PERFORMANCE

Sensitivity, ±5% [1]
 Range F.S
 Frequency Response, ±5%
 Resonant Frequency
 Equivalent Electrical Noise Floor, Max
 Linearity [2]
 Maximum Transverse sensitivity
 Strain Sensitivity @ 250µε

| | | | |
|-----------|--------|-----------|------------------------|
| 100 | mV/g | 10.20 | mV/m/s ² |
| 50 | g pk | 491 | m/s ² pk |
| 1 to 5000 | Hz | 1 to 5000 | Hz |
| >40 | kHz | >40 | kHz |
| 0.003 | g RMS | 0.03 | m/s ² g RMS |
| ± 1% | % F.S. | ± 1% | % F.S. |
| 3 | % | 3 | % |
| 0.002 | g/µε | 0.02 | m/s ² /µε |

ENVIRONMENTAL

Maximum Shock
 Temperature Range
 Seal

| | | | |
|-------------|------|------------|---------------------|
| 3000 | g pk | 29430 | m/s ² pk |
| -60 to +200 | *F | -51 to +93 | *C |
| Epoxy | | Epoxy | |

ELECTRICAL

Supply Current Range [3]
 Compliance Voltage Range
 Output Impedance, Typ
 Bias Voltage
 Discharge Time Constant

| | | | |
|-------------|-------|-------------|-------|
| 2 to 20 | mA | 2 to 20 | mA |
| + 18 to +20 | Volts | + 18 to +20 | Volts |
| <100 | Ω | <100 | Ω |
| 7.5 to 9.5 | VDC | 7.5 to 9.5 | VDC |
| 0.5 to 1.5 | Sec | 0.5 to 1.5 | Sec |

This family also includes:

| Model | Sensitivity (mV/g) | Frequency Response (Hz) | Time Constant (Sec) | Operating Temp (*F) |
|-------|--------------------|-------------------------|---------------------|---------------------|
| | | | | |
| | | | | |

Refer to the performance specifications of the products in this family for detailed description.

Supplied Accessories:

- 1) Accredited calibration certificate (ISO 17025)
- 2) Model 6200 Mounting Studs, qty 2

Notes:

- [1] Measured at 100 Hz, 1 g RMS per ISA RP 37.2
- [2] Measured using zero-based straight line method, % of F.S. or any lesser range.
- [3] Do not apply power to this system without current limiting, 20 mA MAX. To do so will destroy the IC charge amplifier.
- [4] System calibrated at factory with **NIST** traceable transfer standard accelerometer weighing 19 grams. NIST traceability number supplied with each system calibration.
- [5] Mounts in available Model 4200 19-inch wide equipment rack. Up to 10 units fit in one rack.
- [6] In the interest of constant product improvement, we reserve the rights to change the specifications without notice. It is the customer's responsibility to validate that a particular product with the properties described in the product specification is suitable for use in a particular application. Parameters provided in datasheets and / or specifications may vary in different applications and performance may vary over time. All operating parameters, including typical parameters, must be validated for each customer application by the customer's technical experts.

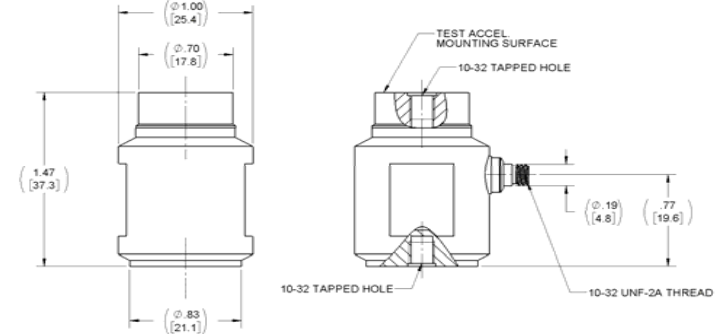
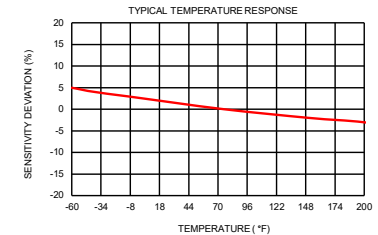
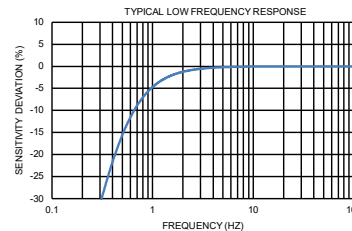

Units on the line drawing are in inches, units in brackets are in millimeters. Refer to 127-3123A for more information.



21592 Marilla Street, Chatsworth, California 91311 Phone: 818.700.7818 Fax: 818.698.0362 www.dytran.com
 For permission to reprint this content, please contact info@dytran.com