

PROPRIETARY AND CONFIDENTIAL

THE INFORMATION CONTAINED IN THIS DRAWING IS THE SOLE PROPERTY OF DYTRAN INSTRUMENTS INC. ANY REPRODUCTION IN PART OR AS A WHOLE WITHOUT THE WRITTEN PERMISSION OF DYTRAN INSTRUMENTS INC. IS PROHIBITED

REVISIONS

REV	ECN	DESCRIPTION	BY/DATE	CHK	APPR
B	12932	REDRAWN IN SOLIDWORKS	RA, 09/09/16	EM	W

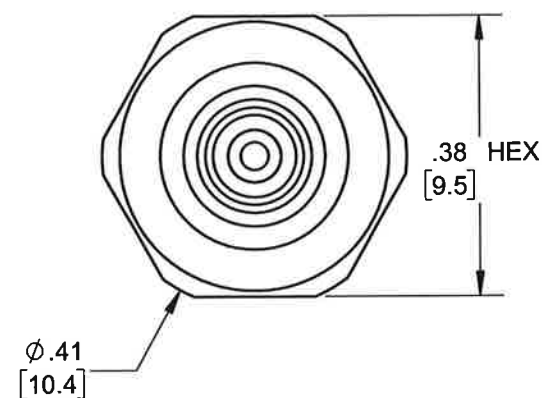

VIEW A-A  
SCALE 4 : 1

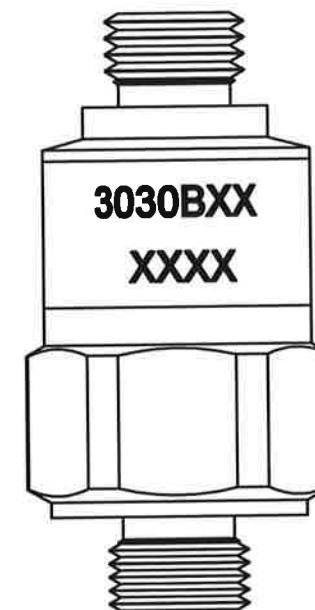
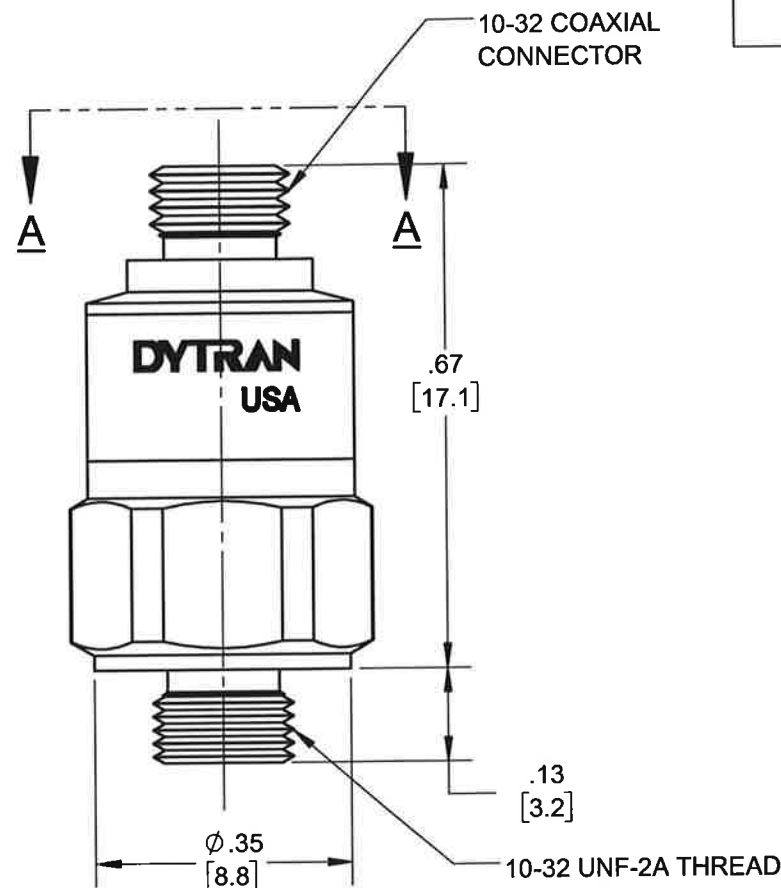
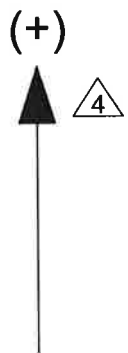

REAR VIEW

MOUNTING RECOMENDATIONS: PREPARE FLAT MOUNTING SURFACE  $\phi .50 [12.7]$  MIN, FLAT TO  $.001$  TIR. DRILL AND TAP 10-32 UNF-2B  $\nabla .15 [3.8]$  MIN. RECOMMENDED MOUNTING TORQUE: 15 LB IN  $+0/-5$  LB IN

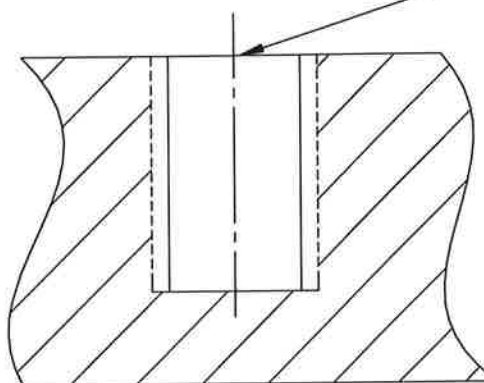

- 4 ARROW INDICATES SENSE AND DIRECTION OF ACCELERATION FOR POSITIVE - GOING OUTPUT SIGNAL
- 3 PREPARE FLAT SURFACE TO THIS DIA. WITH A FINISH OF OR BETTER AND FLAT TO  $.001$  TIR.
- 2 PREPARE MOUNTING SURFACE AS SHOWN. APPLY A LAYER OF SILICONE GREASE TO MOUNTING SURFACE. TORQUE IN PLACE WITH 15 LB-IN.

1. HOUSING MATERIAL: 316L STAINLESS STEEL

NOTES: UNLESS OTHERWISE SPECIFIED

UNLESS OTHERWISE SPECIFIED:  
 INTERPRET DIM & TOL PER ASME Y14.5M - 1994.  
 REMOVE BURRS.  
 COUNTERSINK INTERNAL THDS 90° TO MAJOR DIA.  
 CHAM EXT THDS 45° TO MINOR DIA.  
 THD LENGTHS AND DEPTHS ARE FOR MIN FULL THDS.  
 DIMENSIONS APPLY AFTER FINISHING.

ALL MACHINED SURFACES.  
 TOTAL RUNOUT WITHIN  $.005$ .  
 BREAK SHARP EDGES  $.005$  TO  $.010$ .  
 MACHINED FILLET RADII  $.005$  TO  $.015$ .  
 WELDING SYMBOLS PER AWS A2.4.  
 ABBREVIATIONS PER MIL-STD-12.

UNLESS OTHERWISE SPECIFIED: DIMENSIONS ARE IN INCHES. DIMENSIONS IN BRACKETS [ ] ARE IN MILLIMETERS TOLERANCES ARE:		
DECIMALS	METRIC	ANGLES
.XX $\pm .03$	.X $\pm 0.8$	$\pm 1^\circ$
.XXX $\pm .010$	.XX $\pm 0.25$	
APPROVALS		DATE
ORIG	NC	12/07/95
CHK	NC	06/30/98
APP	NC	06/30/16
DO NOT SCALE DRAWING		THIRD ANGLE PROJECTION



TITLE: **OUTLINE/INSTALLATION DRAWING, 3030B SERIES**

SIZE	CAGE CODE	DWG NO	REV
B	2W033	127-3030B	B
SCALE: 2:1		SHEET 1 OF 1	

Model Number 3030B5	<b>PERFORMANCE SPECIFICATION</b>	DOC NO PS3030B5
<b>MINIATURE IEPE ACCELEROMETER</b>		REV H, ECN 12932, 09/14/16



- MINIATURE SIZE
- EXCELLENT LINEARITY
- HERMETICALLY SEALED

**PHYSICAL**

Weight  
Size  
Connector  
Mounting Provision  
Material  
Element Style

Hex x Height  
Top Mounted  
Integral Stud  
Accelerometer and Connector

ENGLISH		SI	
0.25	oz	7.2	grams
0.375 x 0.67	Inches	9.525 x 17.01	mm
10-32 Micro Coax		10-32 Micro Coax	
10-32 (UNF-2A)		10-32 (UNF-2A)	
17-4 PH/ 304L		17-4 PH/ 304L	
Quartz Compression		Quartz Compression	

**PERFORMANCE**

Sensitivity, ±5% [1]  
Range F.S for ± 5 Volts Output  
Frequency Response, ±5%  
Resonant Frequency  
Equivalent Electrical Noise Floor  
Linearity [2]  
Maximum Transverse sensitivity  
Strain Sensitivity @ 250µε

10	mV/g	1	mV/m/s <sup>2</sup>
±500	g	±4905	m/s <sup>2</sup>
5 to 10000	Hz	5 to 10000	Hz
>30	kHz	>30	kHz
0.007	grms	0.0687	m/s <sup>2</sup> rms
± 1%	% F.S.	± 1%	% F.S.
5	%	5	%
0.003	g/µε	0.03	m/s <sup>2</sup> /µε

**ENVIRONMENTAL**

Maximum Vibration  
Maximum Shock  
Temperature Range  
Seal, Hermetic

±1000	gpeak	±9810	m/s <sup>2</sup> peak
±3000	gpeak	±29430	m/s <sup>2</sup> peak
-148 to +250	°F	-100 to 121	°C
Welded/Glass To Metal		Welded/Glass To Metal	

**ELECTRICAL**

Supply Current Range [3]  
Compliance Voltage Range  
Output Impedance, Typ  
Bias Voltage  
Discharge Time Constant

2 to 20	mA	2 to 20	mA
+ 18 to +30	Volts	+ 18 to +30	Volts
100	Ω	100	Ω
+7.5 to +11.5	VDC	+7.5 to +11.5	VDC
0.1 to 0.3	Sec	0.1 to 0.3	Sec

**This family also includes:**

Model	Sensitivity (mV/g)	Frequency Response (Hz)	Time Constant (Sec)	Operating Temp (°F)
3030B4	10	2 to 10000	0.5 to 1	-60 to 250
3030B5H	10	5 to 10000	0.1 to 0.3	-60 to 325

Please refer to the performance specifications of the products in this family for detailed description

**Supplied Accessories:**

- 1) Accredited calibration certificate (ISO 17025)

**Notes:**

- [1] Measure at 100Hz, 1 grms per ISA RP 37.2
- [2] Measure using zero-based straight line method, % of F.S. or any lesser range.
- [3] Do not apply power to this system without current limiting, 20 mA MAX. To do so will destroy the IC charge amplifier.

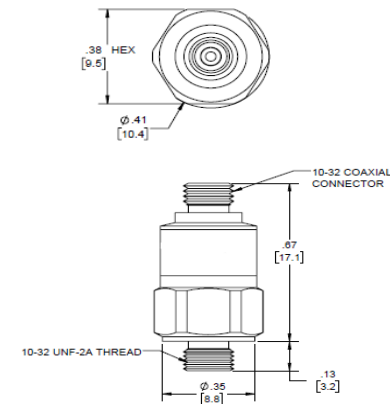
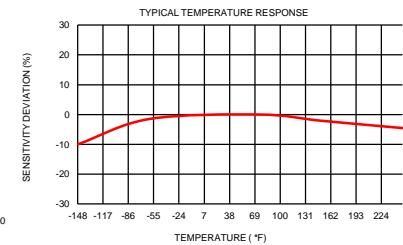
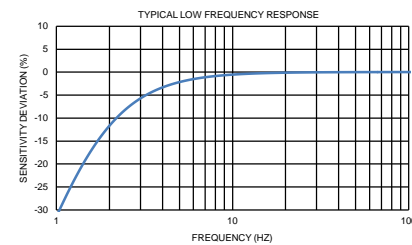

Units on the line drawing are in inches, units in brackets are in millimeters. Refer to 127-3030B for more information.



21592 Marilla Street, Chatsworth, California 91311 Phone: 818.700.7818 Fax: 818.700.7880 www.dytran.com  
For permission to reprint this content, please contact info@dytran.com